

PRODUCTS

MACHINE TOOL SPINDLES

- CNC & Conventional turning machines.
- VMC, HMC, HBM.
- ID (Belt driven and motorized), OD & Surface grinders.
- Custom Designed Spindles
 - Crank shaft grinders (wheel spindles, crank head spindles).
 - Live & Dead centers for heavy duty grinders.
 - Hydrostatic & Hydrodynamic Spindles

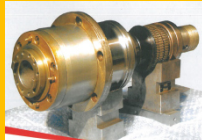
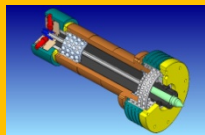

ALIGNMENT TOOLS

- Three piece Jig for VMC/ HMC- ATC alignment with spindle.
- Alignment mandrels for all type machine tool inspection.
- BT-30, BT-40, BT-50, HSK-100 Morse Taper Serial.

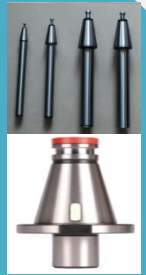

MFG. FACILITY

- CYL. Grinding machines-
OD 550 X 8000 mm
ID 450 X 400 mm
- Surface grinding -
350 X 1500 mm
- Thread grinding -
260 X 1100 mm
- Spline grinding -
300 X 1800 mm
- CNC Machines-
HMC/ VMC/Turning



MIKRON

(AN ISO 9001-2000 COMPANY)

"Pushing the boundaries of engineering Excellence."

Our Associate Company



SOLID
SOLUTIONS

SERVICES

- Reconditioning all types of machine tool spindles, changing of bearings.
- Also we have developed an in house facility for grinding, Spindles of HMC/VMC which have no unwanted noise and heat generation.
- Providing 0.002 mm accuracy with maximum removal of 0.05 mm material from bore dimensionally, without dismantling the assembly.
- Providing the inspection report of spindle on 300 mm long alignment mandrel.
- Precision ball screw end support grinding & thread grinding.
- Development of SPM(CNC/PLC), JIGS & Fixtures, steady rests , special tooling's, in process measuring systems, machine tool sub-assemblies, crank shaft – pot chucks, Assembly fixtures & Test Rigs.
- Job works on turning center, VMC/HMC.

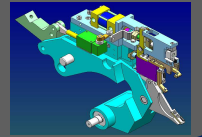
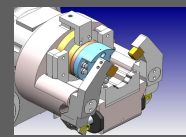

19/8, F-2 Block, MIDC
Pimpri, Pune- 411018



020 – 65330779
9371025370 /9371024601
9922437021



www.mikronpune.com



mikron@reddiffmail.com
mikronpimpri@gmail.com

Our Major Customers

